

# Lever Selection



## Lever Specifications

Door Specs	2 1/8" Face Bore 1" Edge Bore 2 3/8" or 2 3/4" Backset Box Pack: Latch Face 1" x 2 1/4" RC (Round Corner) SC (Square Corner, optional)
Latch	Box Pack: Adjustable 2 3/8" to 2 3/4" RC RC (Round Corner)
Door Thickness	1 3/8" to 1 3/4"
Cylinder	5 Pin Cylinder (KW-1 Compatible) SC-1, PARA optional
Keying	Box Pack: KD (Keyed Different) KA3 (Keyed Alike) Clear Pack: KA3 (Keyed Alike in sets of 3)
Faceplate	1" W x 2 1/4" H RC (Round Corner)
Strike	Box Pack: 2 1/4" Full Lip RC (Round Corner)
Certified ANSI/BHMA	A156.2 Series 4000 Grade 3 <b>BHMA</b> CERTIFIED

DIMENSIONS	A	B	C	FUNCTIONS
<b>MESA</b>	2 9/16"	2 3/8"	3 1/4"	<b>LEVER</b> <b>DUMMY</b> 81
<b>NIAGARA</b>	2 9/16"	2 1/2"	4 7/32"	<b>PASSAGE</b> 101
<b>PRAIRIE</b>	2 9/16"	2 1/4"	3 7/8"	<b>ONE SIDED w/Plate</b> 161
<b>SAVANNAH</b>	2 9/16"	2 7/16"	4 19/64"	<b>PRIVACY</b> 201
<b>WOODLAND</b>	2 9/16"	2 5/8"	3 7/8"	<b>BATH*</b> 221
<b>VIDALIA</b>	2 9/16"	2 1/2"	4 5/8"	<b>ENTRY Knob/Lever</b> 701 <b>ENTRY Lever/Lever</b> 771 <b>ENTRY SFIC**</b> 74LC

\*Bath: Privacy with US26 interior finish

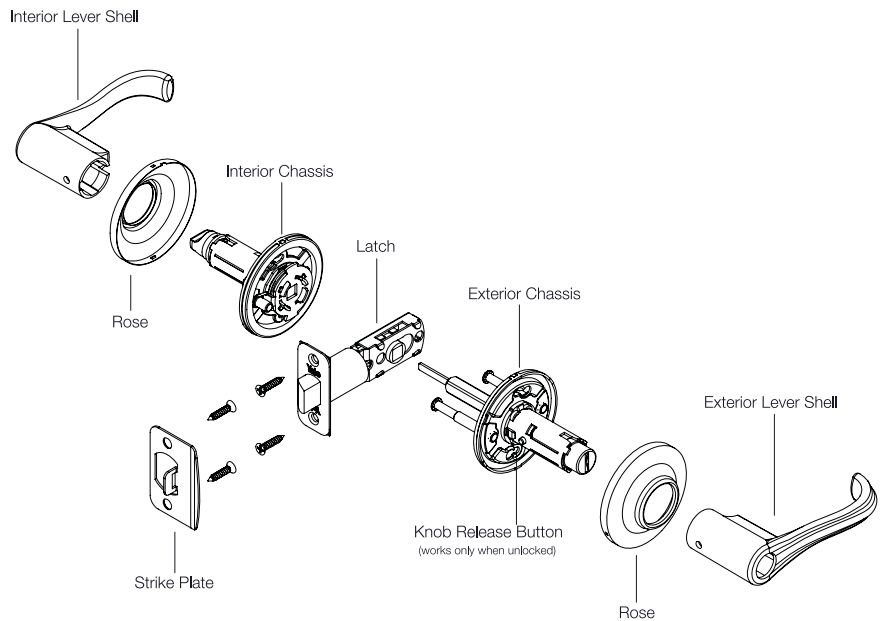
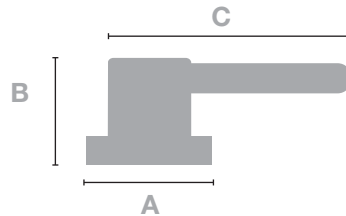

## Lever rosettes

Select an upgrade for any lever styles in Oil Rubbed Bronze Permanent, Satin Nickel, Polished Chrome, or Suede Black.

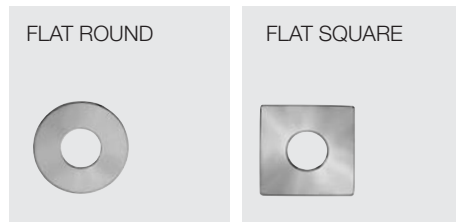

QuickShip™	US3	US5	US10BP	US10BE	US15	US15A	US26	US26D	GM	BSP
<b>MESA</b>										
<b>NIAGARA</b>										
<b>PRAIRIE</b>										
<b>SAVANNAH</b>	•		•		•	•	•	•	•	•
<b>WOODLAND</b>		•	•		•	•	•	•	•	•
<b>VIDALIA</b>			•		•			•		•